

DATA SHEET



DEVICE NUMBER : LI-HB-80W

● Features:

1. Light source: 1x80W integrated LED (45mil Bridgelux LED chip)
2. Total Power Consumption: 80-85 Watt
3. Efficiency: >91%
4. PF>0.96
5. Size: $\Phi 420 \times H 475 \text{mm}$
6. Working Voltage: 85-265V AC
7. LED View Angle(2θ): 60 degree
8. Material Fixture: Aluminum: ZL102 Mn0.2~0.5, mg<=0.25, Si<=0.65
9. With Meanwell driver, stable quality and high efficiency

● Applications:

Apply to workshop, factory building, warehouse, highway toll stations, gas stations, supermarkets, exhibition halls, stadiums and other places of lighting required.

● **Dimensions(mm):**

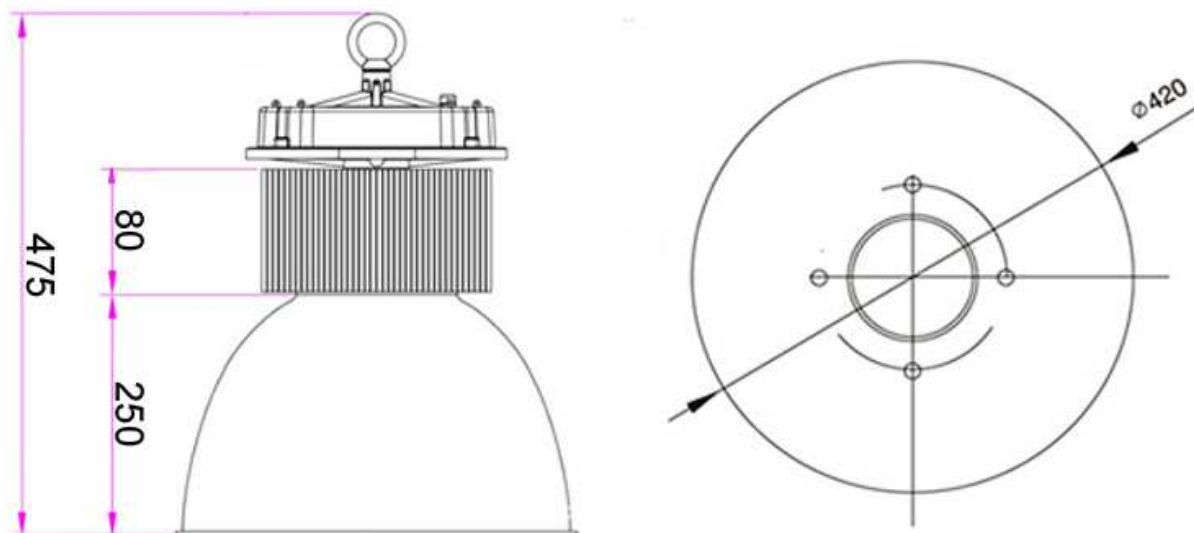

Notes:

1. All dimensions are in millimeters
2. Tolerance is ± 0.5 mm unless other specified.

● **Parameter:**

Input voltage	AC85V-265V	
Frequency Range	50HZ-60Hz	
Power factor	>0.96	
LED working voltage	DC 30-36V	
LED consumption	80W	
Total Power consumption	80-85W	
LED luminous efficiency	90-100lm/W	
Lamp's efficiency	$>91\%$	
Color temperature	Warm white	2800-3200K
	Neutral white	4000-4500K
	Pure white	6000-7000K
Color Index	WW	Ra > 78

	NW, PW	Ra > 82
LED Junction temperature	≤ 75°C	
Light design	LED + reflector secondary light distribution	
Working temperature	-20°C — +50°C	
Storage temperature	-40°C — +65°C	
IP Grade	IP54	
Working life-span	> 50,000H	
Connect wire	Brown	L
	Blue	N
	Yellow/Green	G
Beam angle	60 deg	

● Installation Instruction:

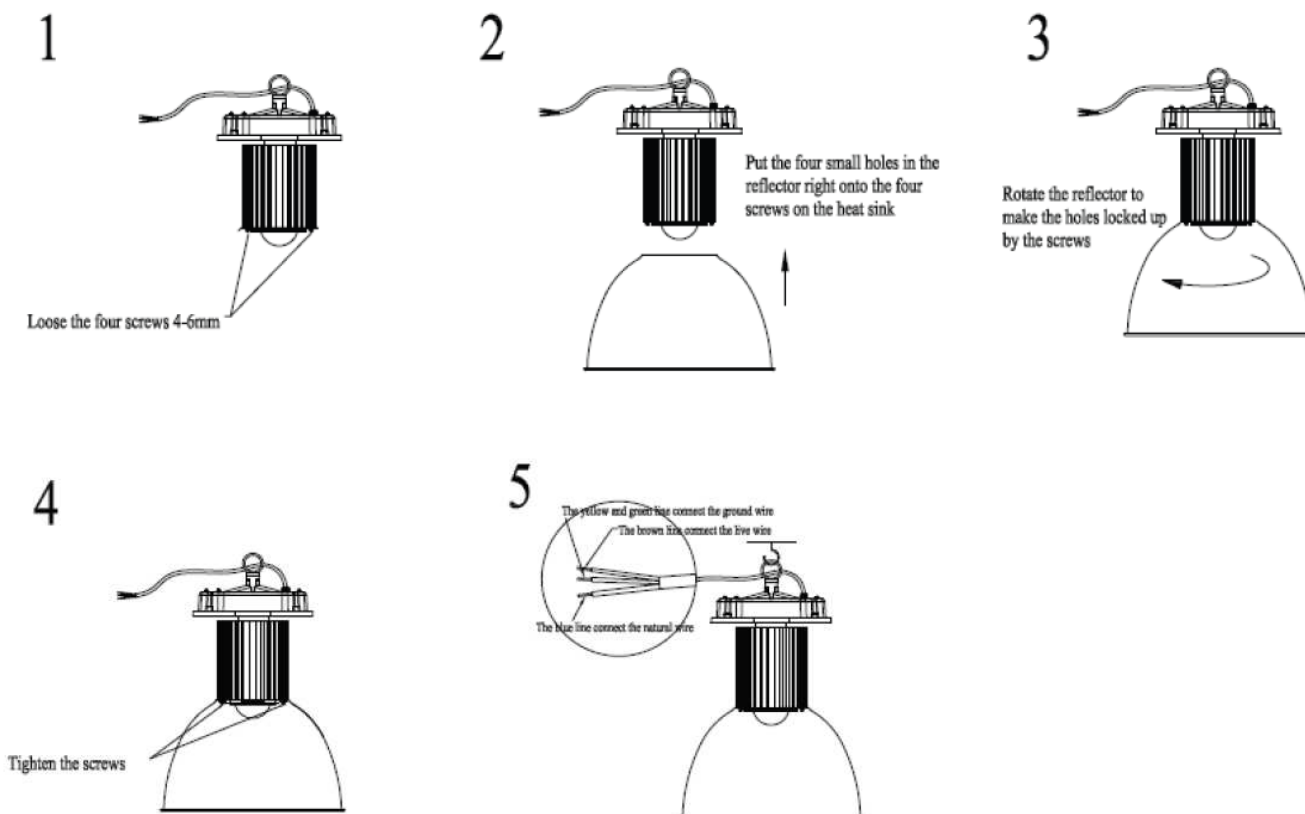

● **Optical Data:**

Lumens	7040		
Beam View Angle	60°		
Candela	8363.2 cd		
Optical Lens efficiency	0.9		
Distance (m)	LUX	Spread (m)	Coverage Area
1	7526.85	1.16	1.05
4	470.43	4.62	16.76
7	153.61	8.09	51.32
10	75.27	11.55	104.72
12	52.27	13.86	150.8

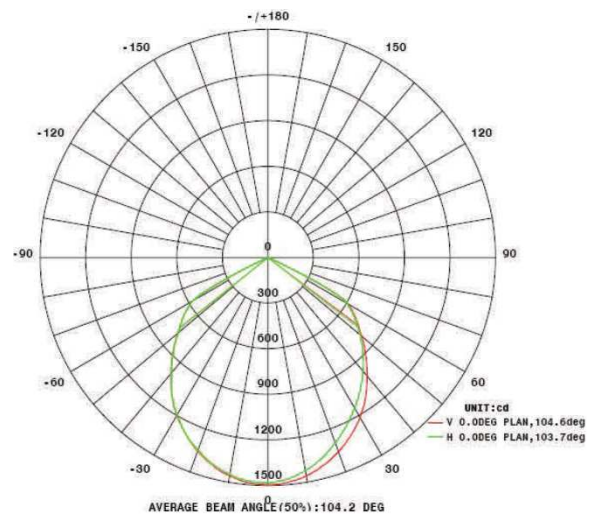
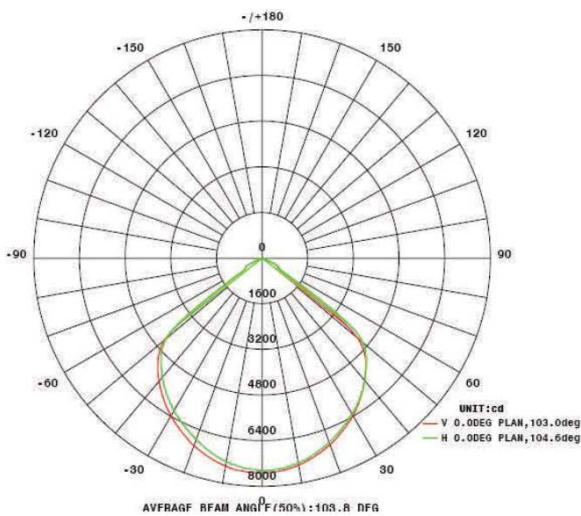
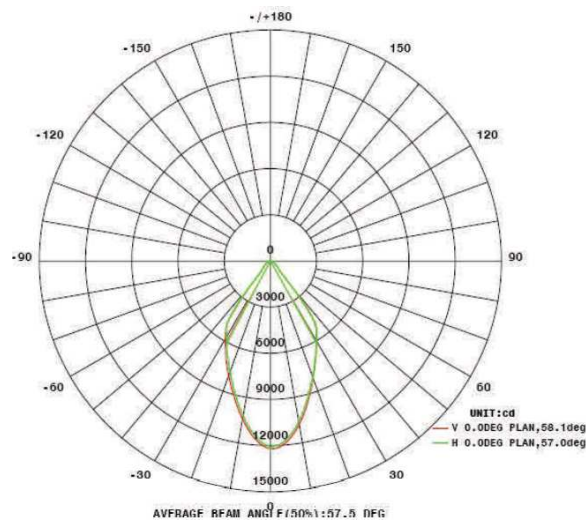

● **Package Method :**

Lamp Body

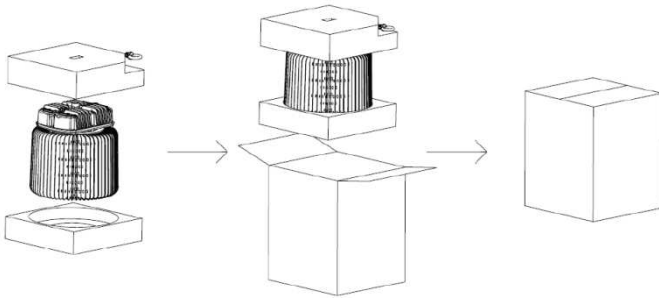

Reflector

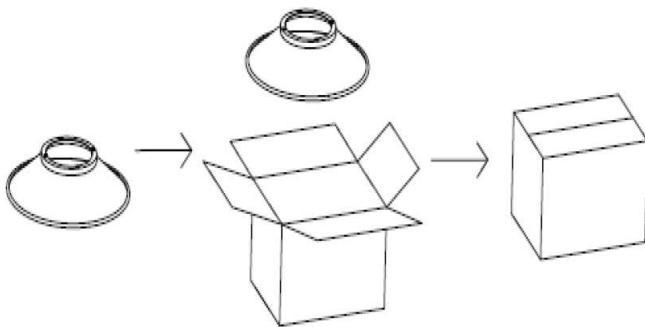

● **Installation Caution:**

1. Make sure the power has been turned off before maintenance.
2. Clean the lens cover regularly to maintain high transmission of light.
3. Clean up the dust from the reflector and heatsink regularly to keep sound heat dispersion.
4. Be careful not to use water or corrosive solution for cleaning, preferably with a dry cloth.
5. When install or replace power supply, directly open the back cover with a screwdriver, then remove the power supply. There are three-core cable of AC power, red corresponds to the power of “L”, blue to “N”, and green to yellow to “G”.