

## DATA SHEET



DEVICE NUMBER : LI-HB-50W

### ● Features:

1. Light source: 1x50W integrated LED (45mil Bridgelux LED chip)
2. Total Power Consumption: 50-55 Watt
3. Efficiency: >90%
4. PF>0.95
5. Size:  $\Phi 420 \times H 475$ mm
6. Working Voltage: 85-265V AC
7. LED View Angle( $2\theta$  1/2): 60 degree
8. Material Fixture: Aluminum: ZL102 Mn0.2~0.5, mg<=0.25, Si<=0.65
9. With Meanwell driver, stable quality and high efficiency

### ● Applications:

Apply to workshop, factory building, warehouse, highway toll stations, gas stations, supermarkets, exhibition halls, stadiums and other places of lighting required.

● **Dimensions(mm):**

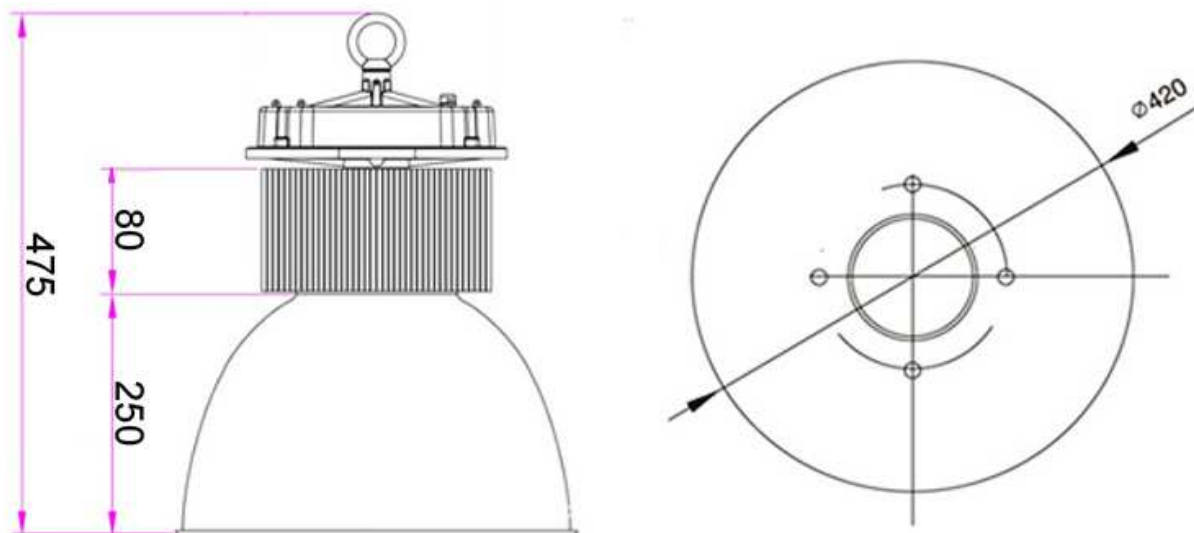

Notes:

1. All dimensions are in millimeters
2. Tolerance is  $\pm 0.5$ mm unless other specified.

● **Parameter:**

<b>Input voltage</b>	AC85V-265V	
<b>Frequency Range</b>	50HZ-60Hz	
<b>Power factor</b>	>0.95	
<b>LED working voltage</b>	DC 30-36V	
<b>LED consumption</b>	50W	
<b>Total Power consumption</b>	50-55W	
<b>LED luminous efficiency</b>	90-100lm/W	
<b>Lamp's efficiency</b>	>90%	
<b>Color temperature</b>	Warm white	2800-3200K
	Neutral white	4000-4500K
	Pure white	6000-7000K
<b>Color Index</b>	WW	Ra>78

	NW, PW	Ra>82
<b>LED Junction temperature</b>	≤ 75°C	
<b>Light design</b>	LED + reflector secondary light distribution	
<b>Working temperature</b>	-20°C——+50°C	
<b>Storage temperature</b>	-40°C——+65°C	
<b>IP Grade</b>	IP54	
<b>Working life-span</b>	> 50,000H	
<b>Connect wire</b>	Brown	L
	Blue	N
	Yellow/Green	G
<b>Beam angle</b>	60 deg	

● **Installation Instruction:**

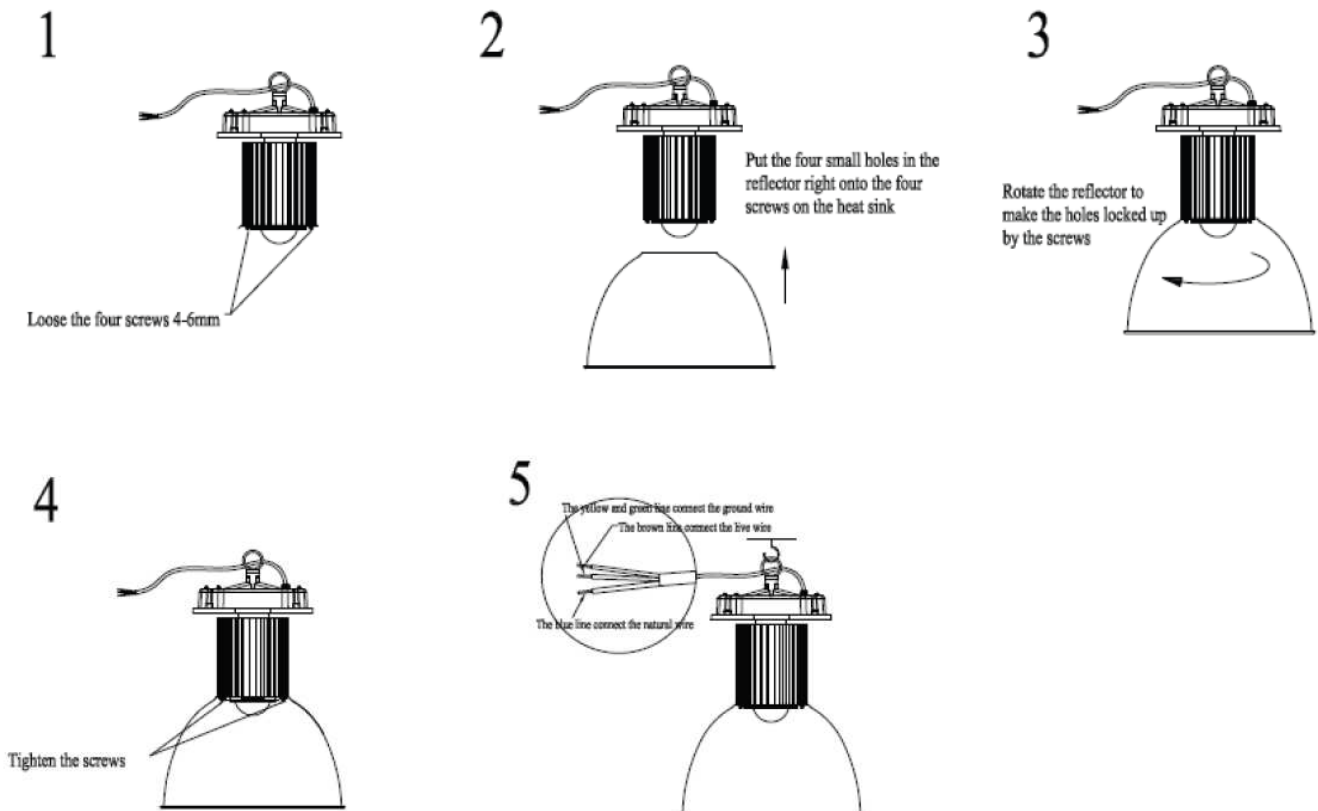

● **Optical Data:**

<b>Lumens</b>	4400		
<b>Beam View Angle</b>	60°		
<b>Candela</b>	5227 cd		
<b>Optical Lens efficiency</b>	0.9		
<b>Distance (m)</b>	<b>LUX</b>	<b>Spread (m)</b>	<b>Coverage Area</b>
1	4704.28	1.16	1.05
4	294.02	4.62	16.76
7	96.01	8.09	51.32
10	47.05	11.55	104.72
12	32.67	13.86	150.8

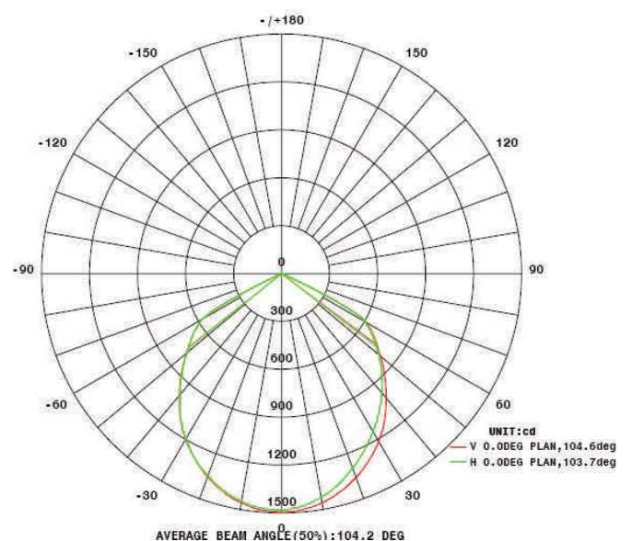
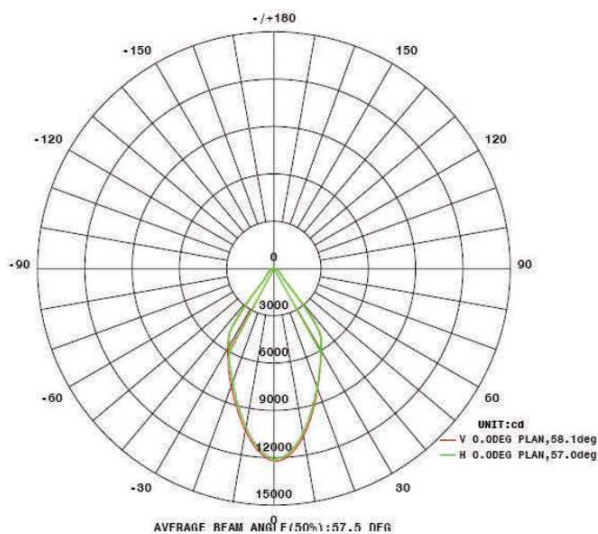
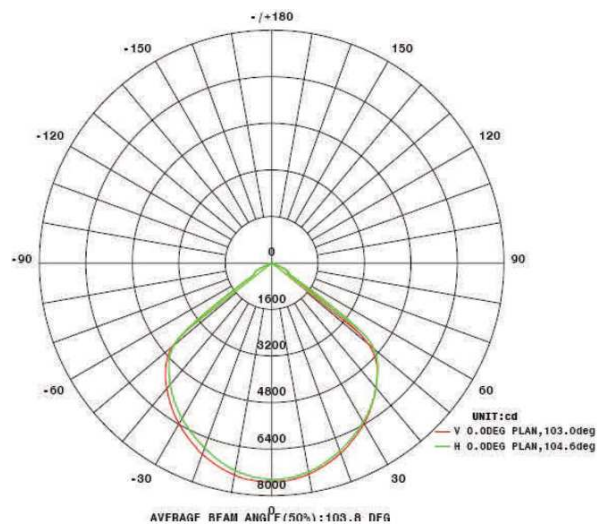

● **Package Method :**

Lamp Body

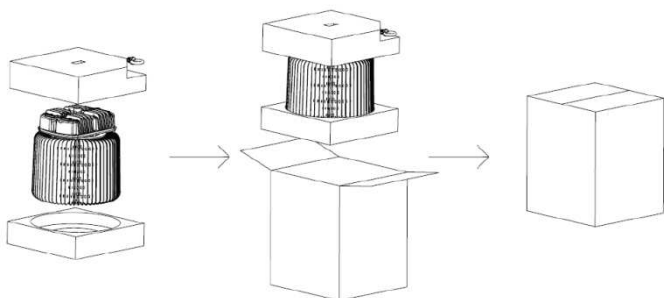

Reflector

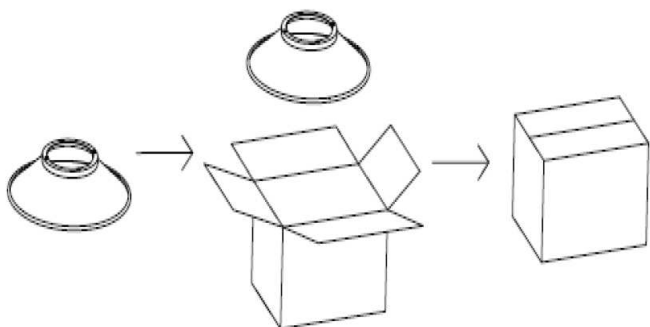

● **Installation Caution:**

1. Make sure the power has been turned off before maintenance.
2. Clean the lens cover regularly to maintain high transmission of light.
3. Clean up the dust from the reflector and heatsink regularly to keep sound heat dispersion.
4. Be careful not to use water or corrosive solution for cleaning, preferably with a dry cloth.
5. When install or replace power supply, directly open the back cover with a screwdriver, then remove the power supply. There are three-core cable of AC power, red corresponds to the power of “L”, blue to “N”, and green to yellow to “G”.